

134502190...  
2427020.../39  
2427019.../39  
5107451  
5107449  
5107450  
5107448

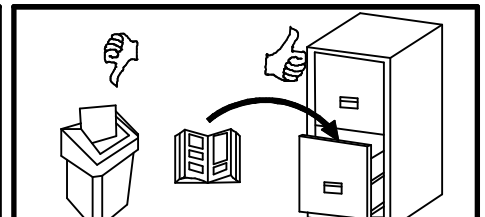

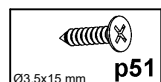

A	B1	B2	C1	C2	C3	D
1	S588-0003	-.4	1916	396	15	3/3
2	S588-1012	-.7	1922	502	15	2/3
3	S588-1013	-.7	1922	502	15	2/3
4	S588-2008	-.5	800	520	15	1/3
5	S588-3014	-.3	769	480	15	1/3
6	S588-3037	-	769	480	15	1/3
7	S588-9301	-.2	1925	779	2,5	2/3
8	dr-762		762	22	15	1/3

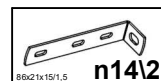
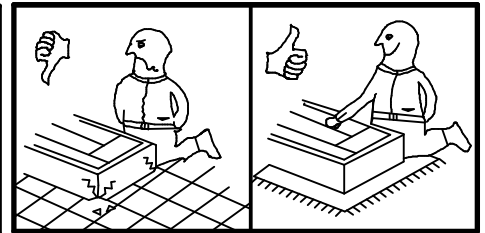
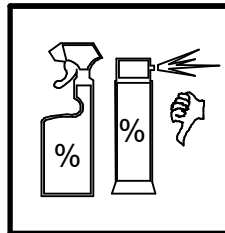
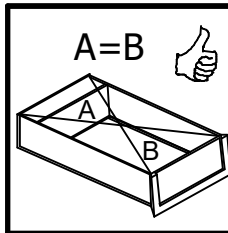
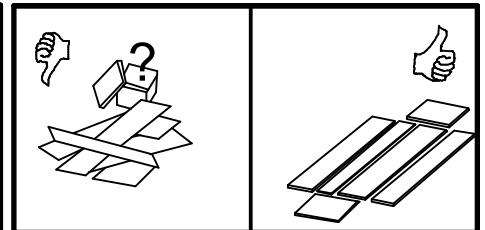
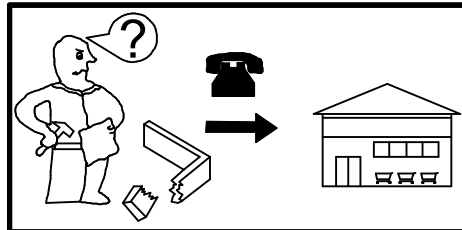
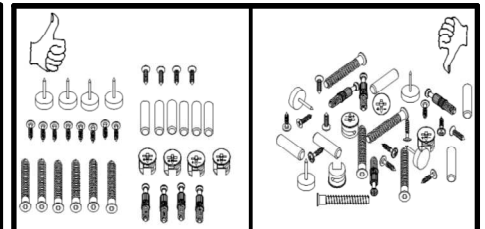
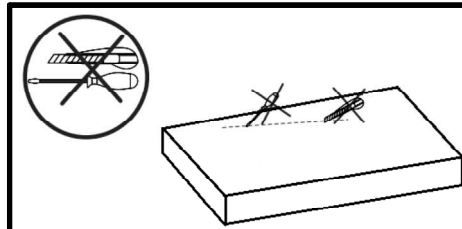
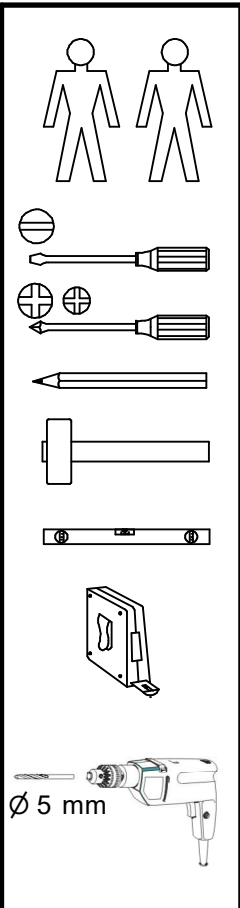
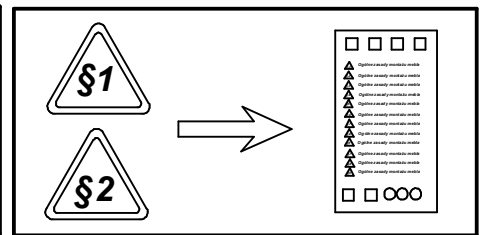
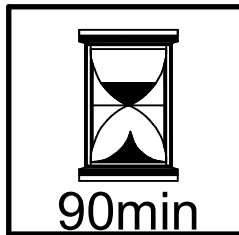
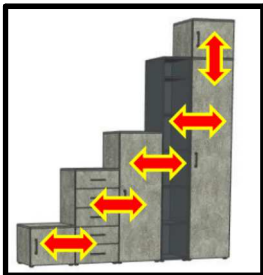
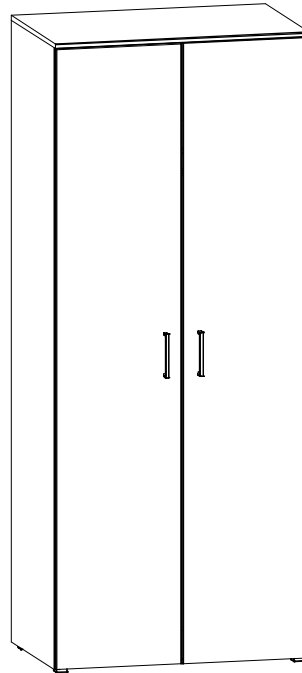
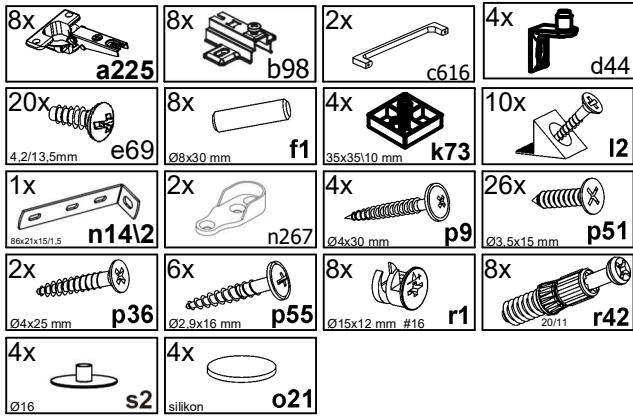
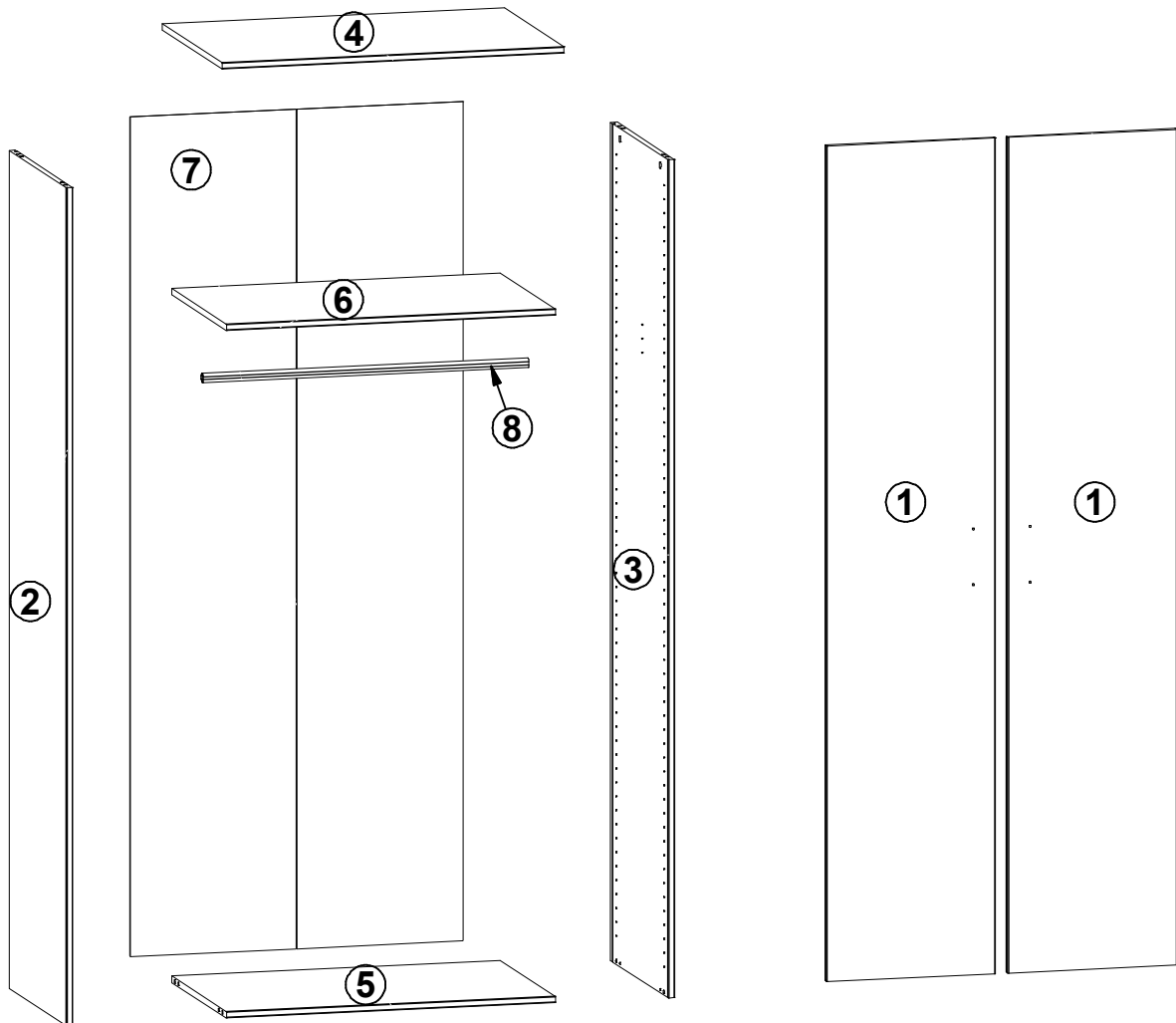

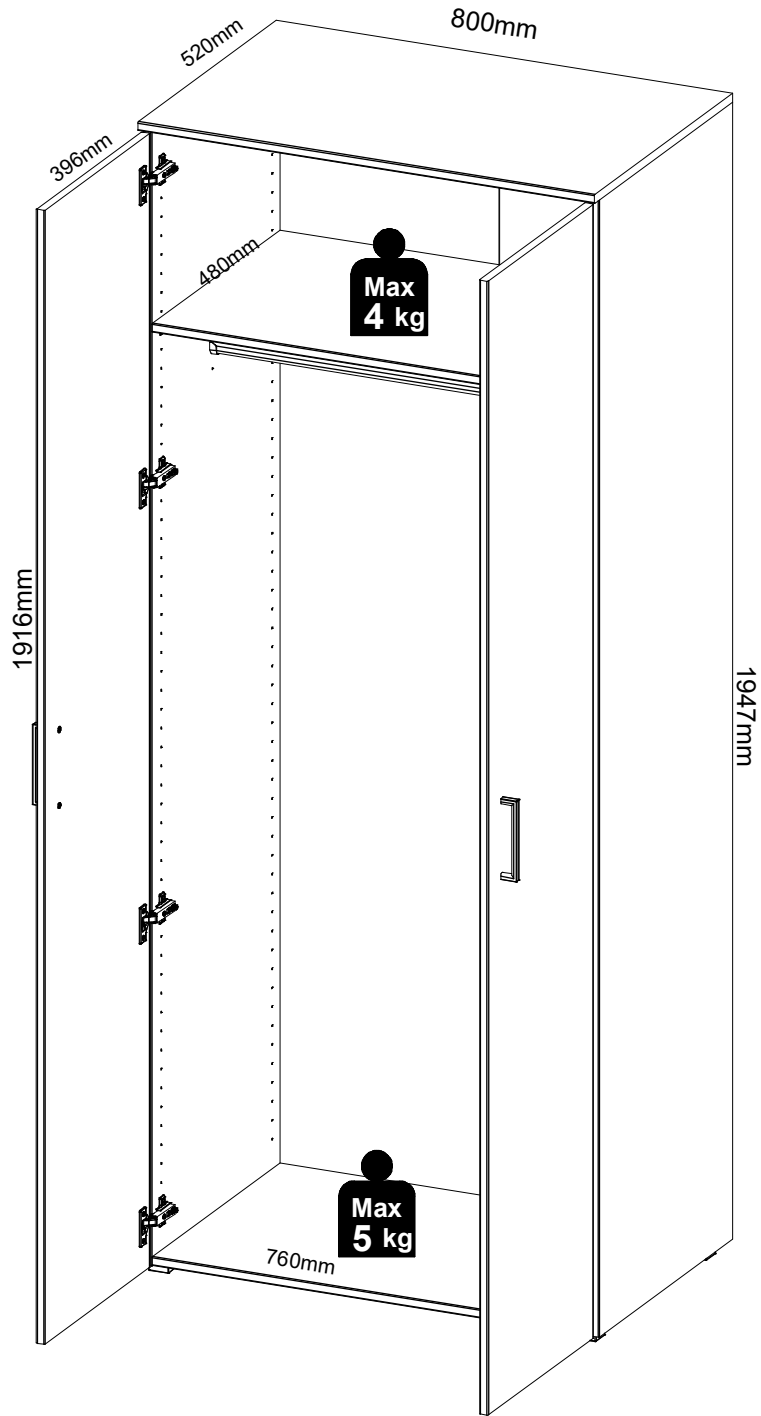

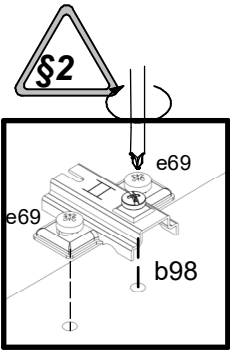

8x 4,2/13,5mm e69	4x b98	2x Ø3,5x15 mm p51	1x n267	2x Ø8x30 mm f1	2x Ø15x12 mm #16 r1	2x r42
-------------------------	-----------	-------------------------	------------	----------------------	---------------------------	-----------

1 ▶

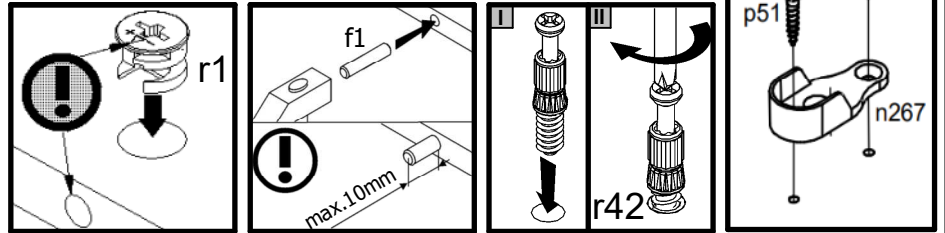
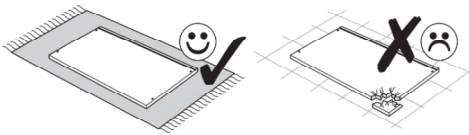
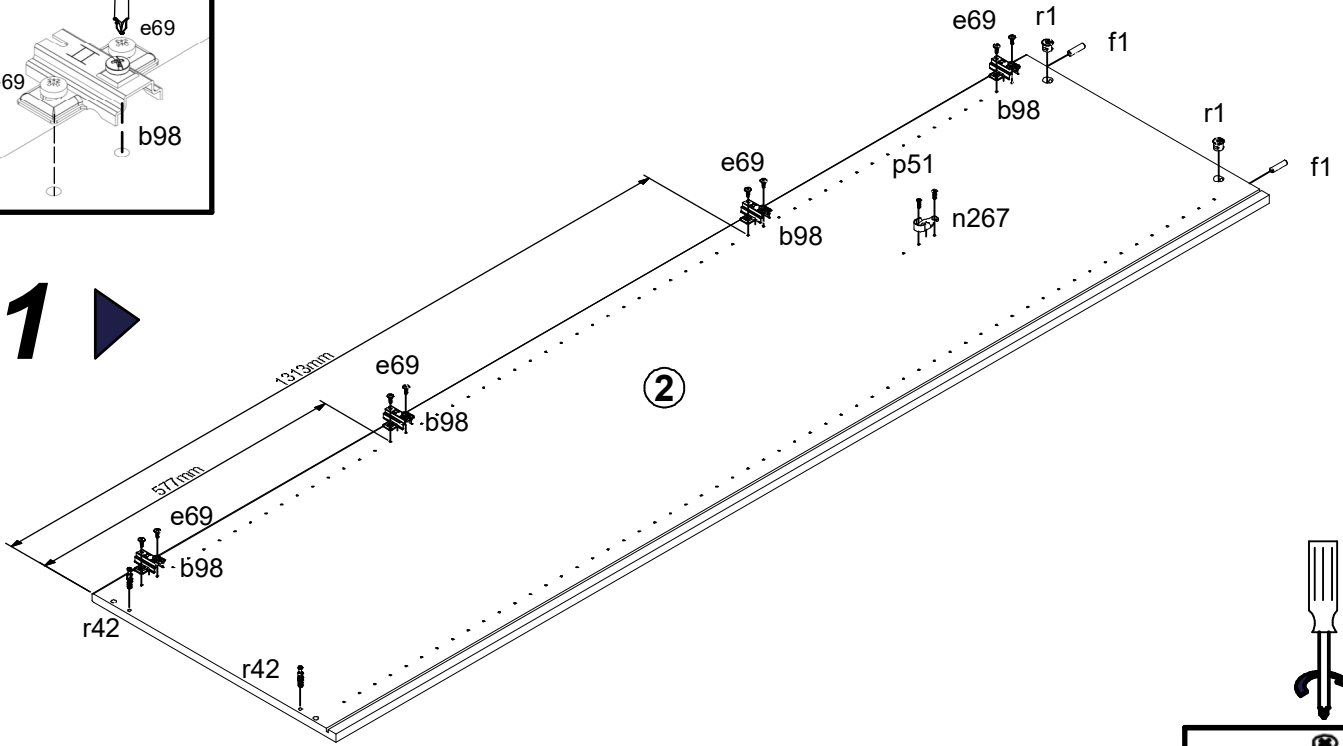

2 ▶

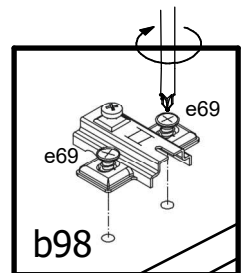
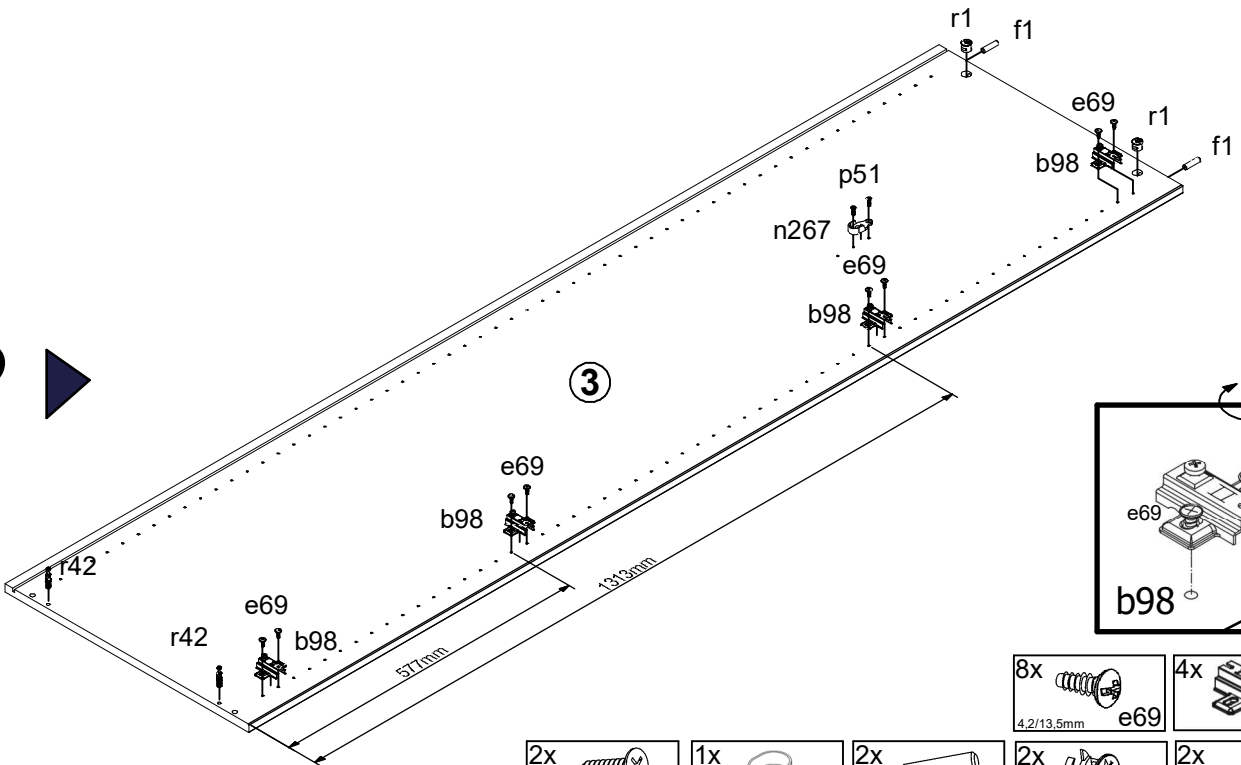

2x Ø3,5x15 mm p51	1x n267	2x Ø8x30 mm f1	2x Ø15x12 mm #16 r1	2x r42	8x 4,2/13,5mm e69	4x b98
-------------------------	------------	----------------------	---------------------------	-----------	-------------------------	-----------

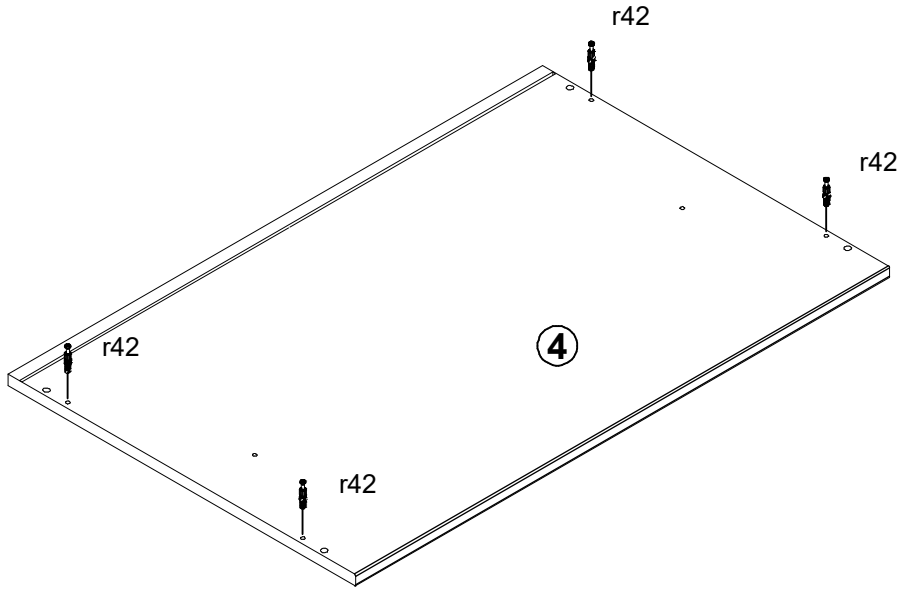

3

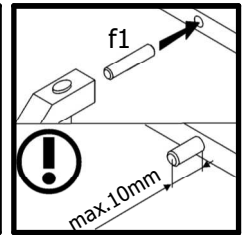
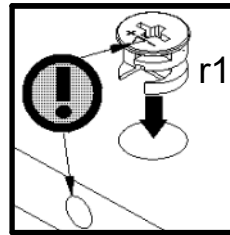
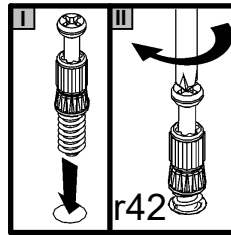
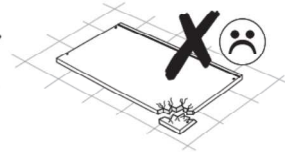
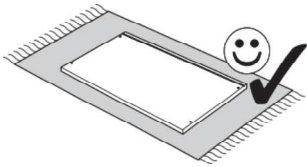

4

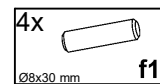
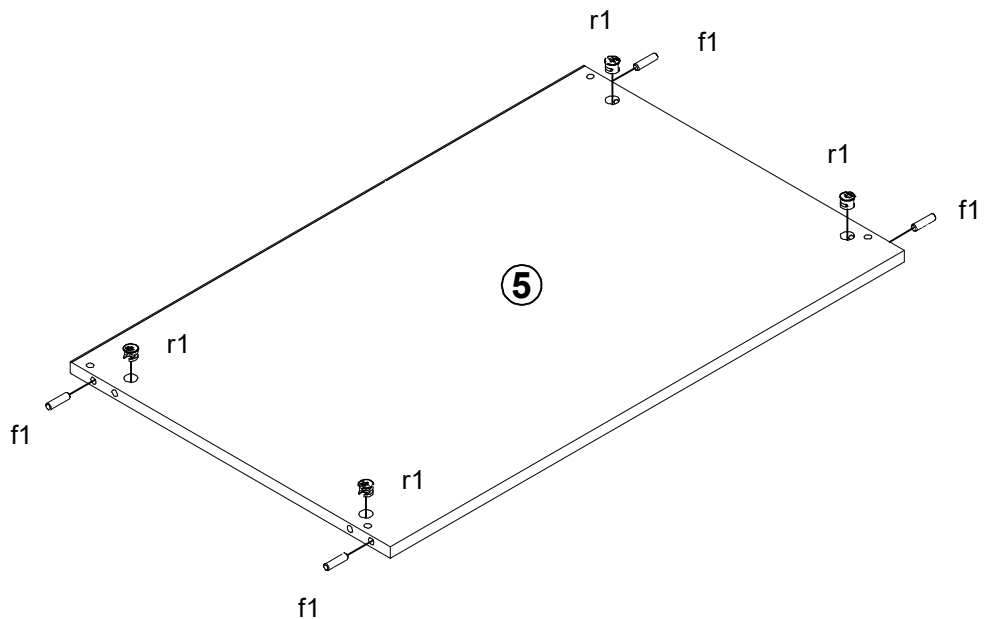

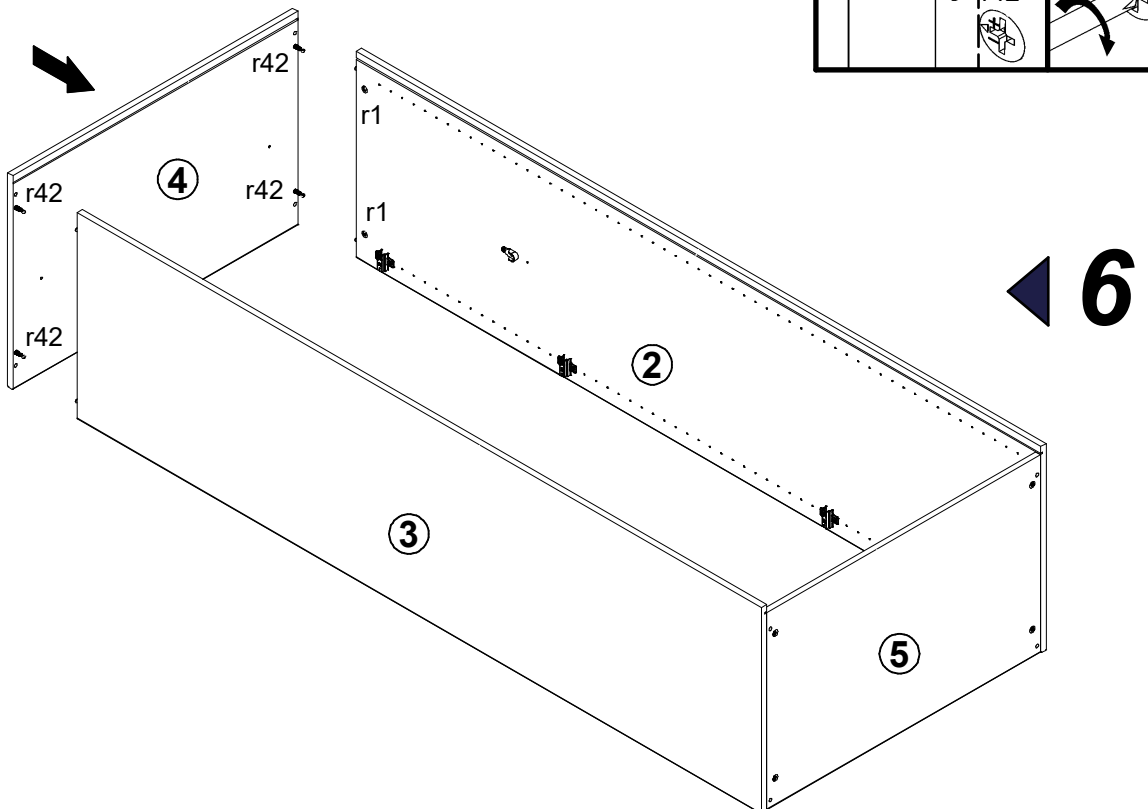
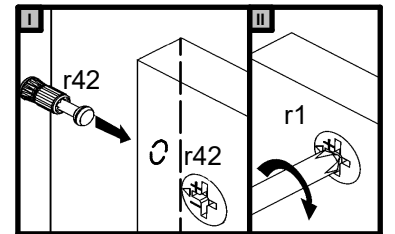
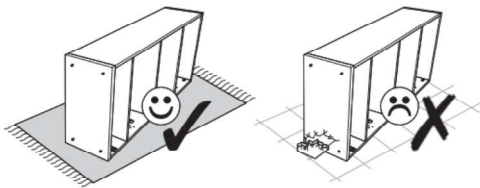
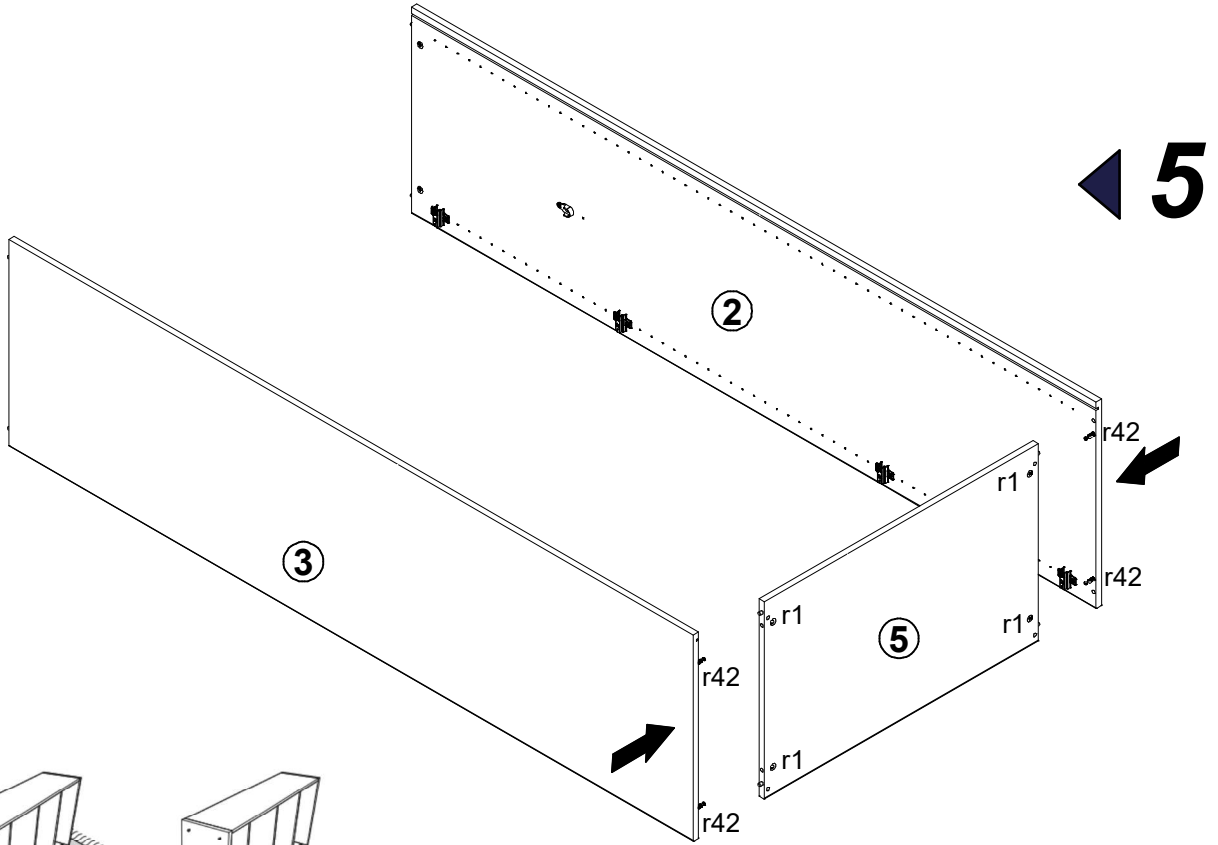

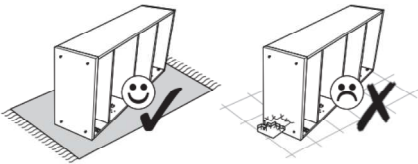
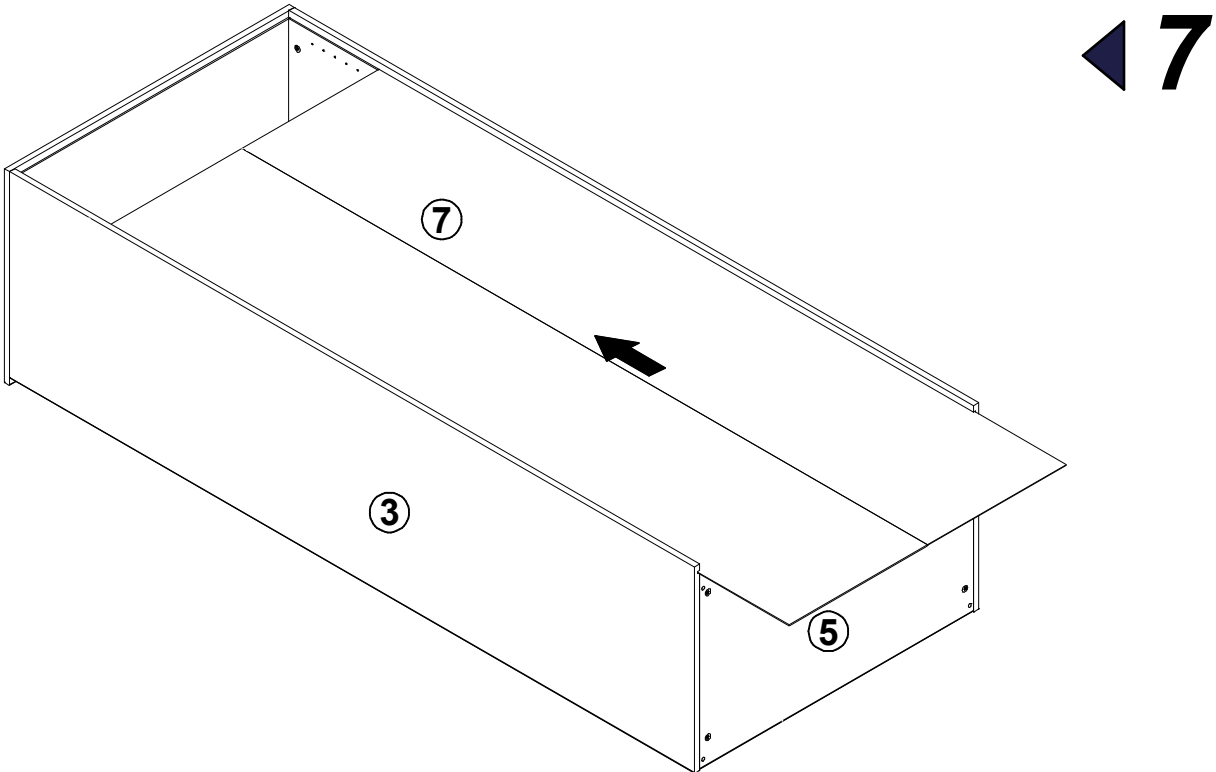

8 ▶

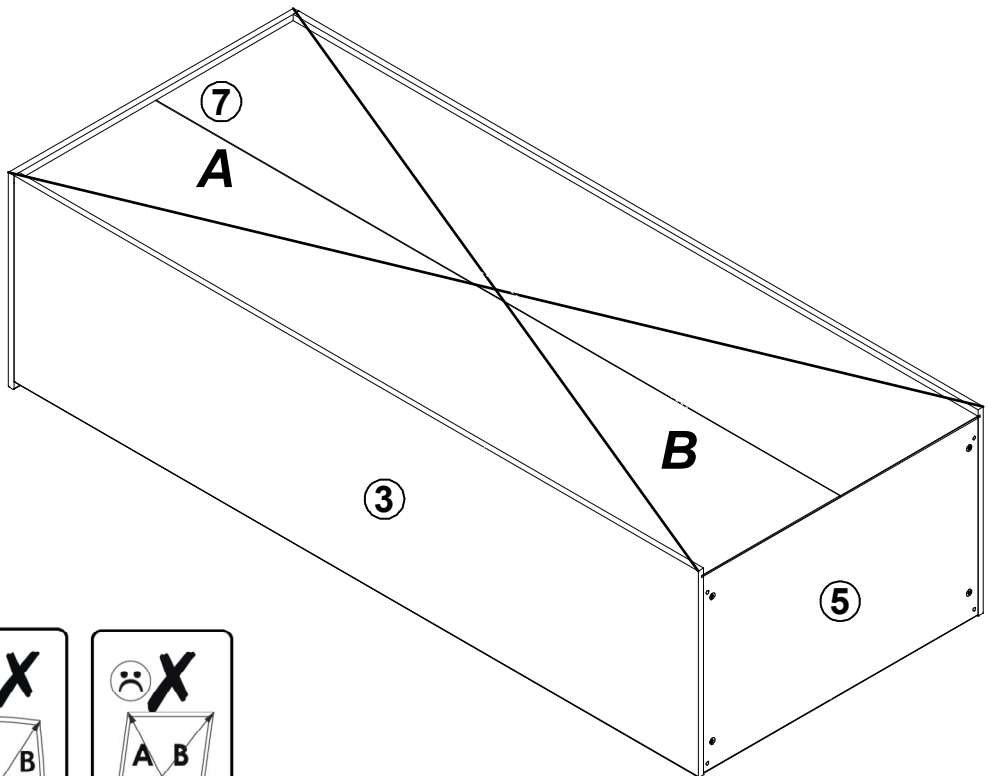

⚠  
**A=B**

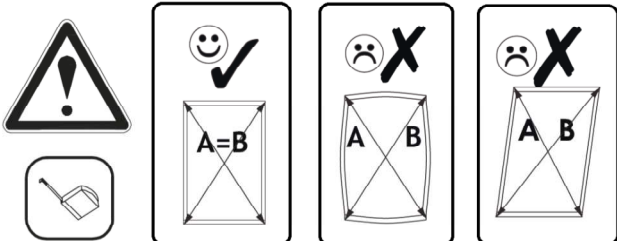

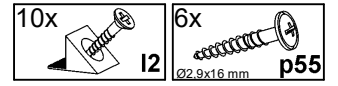

9 ▶

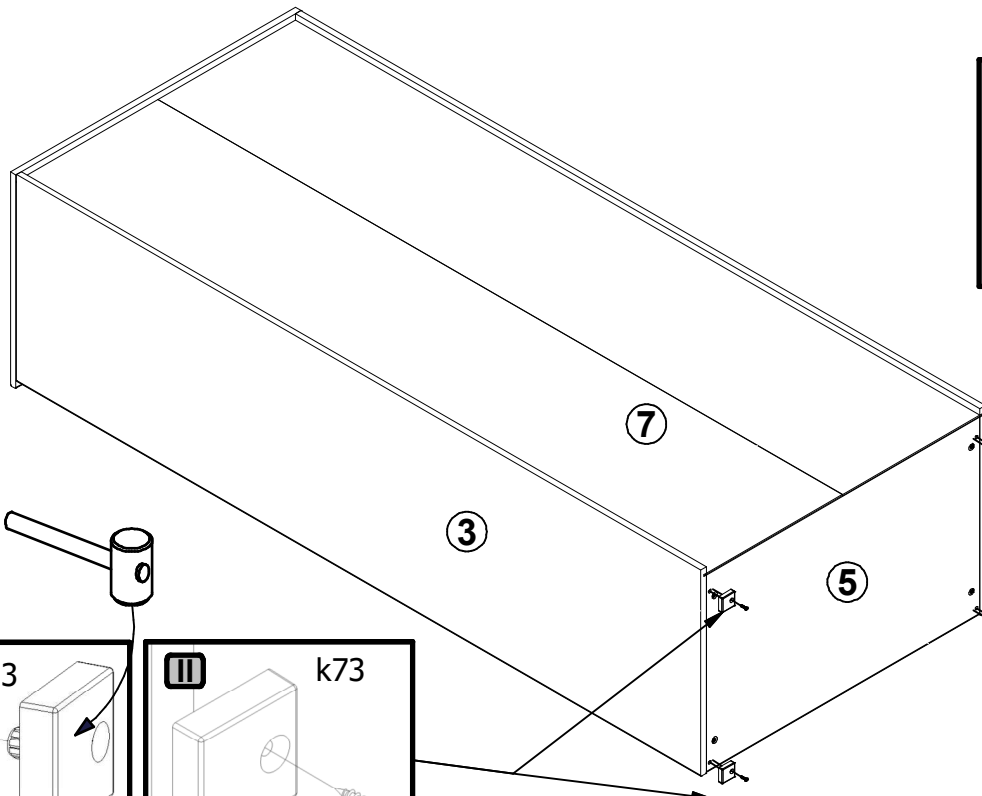
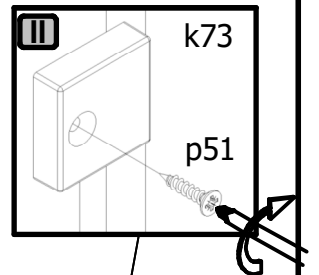
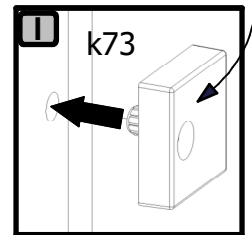
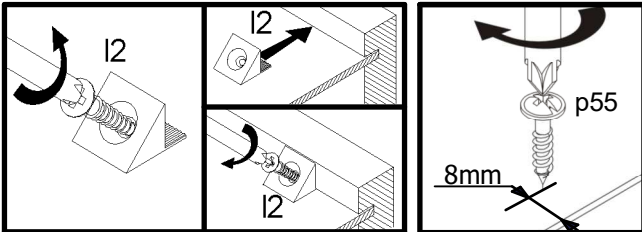
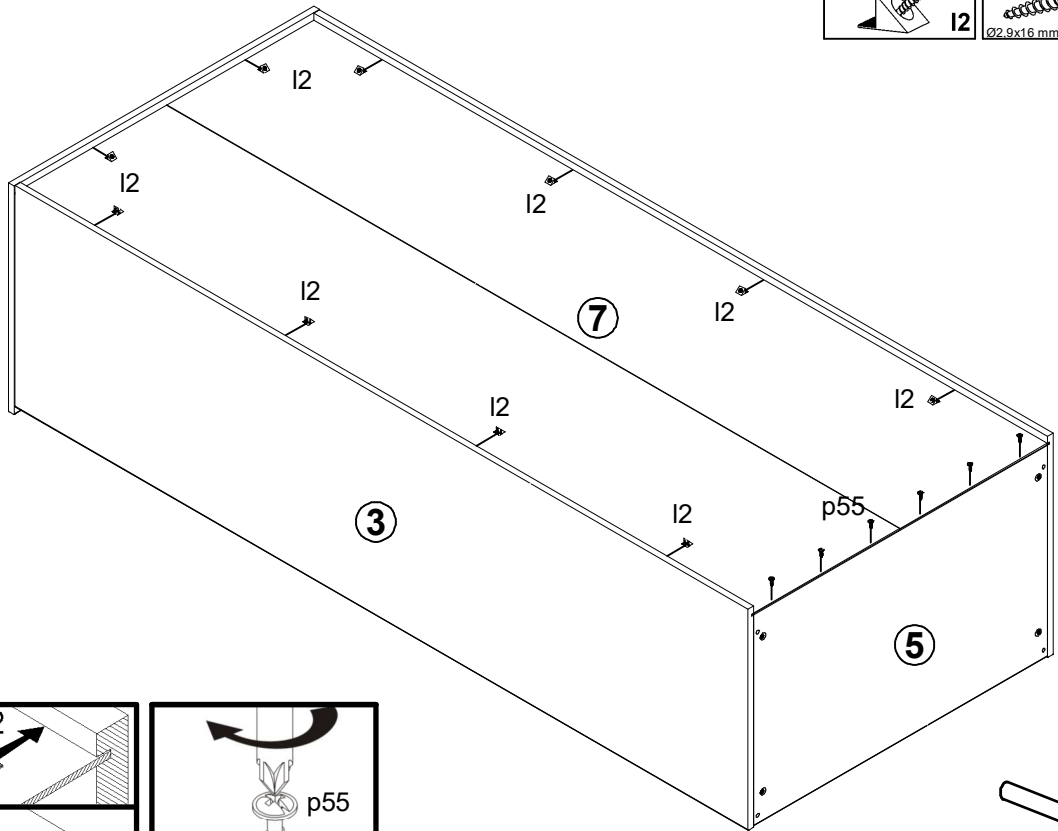

▶ 10

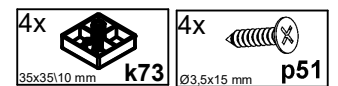
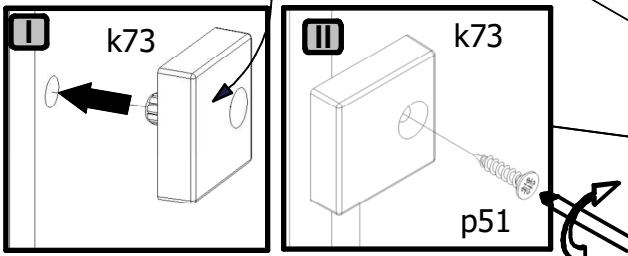



- 4x  s2
- 4x  d44
- 4x  e69

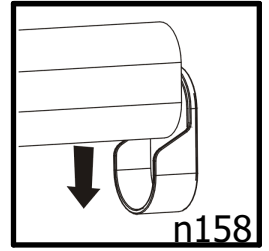

11

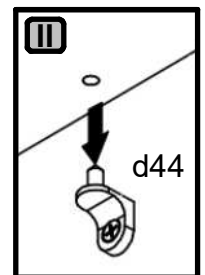
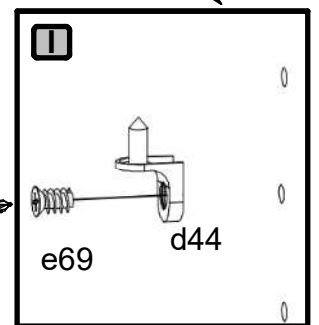
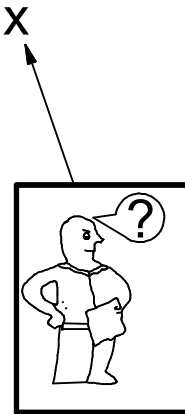
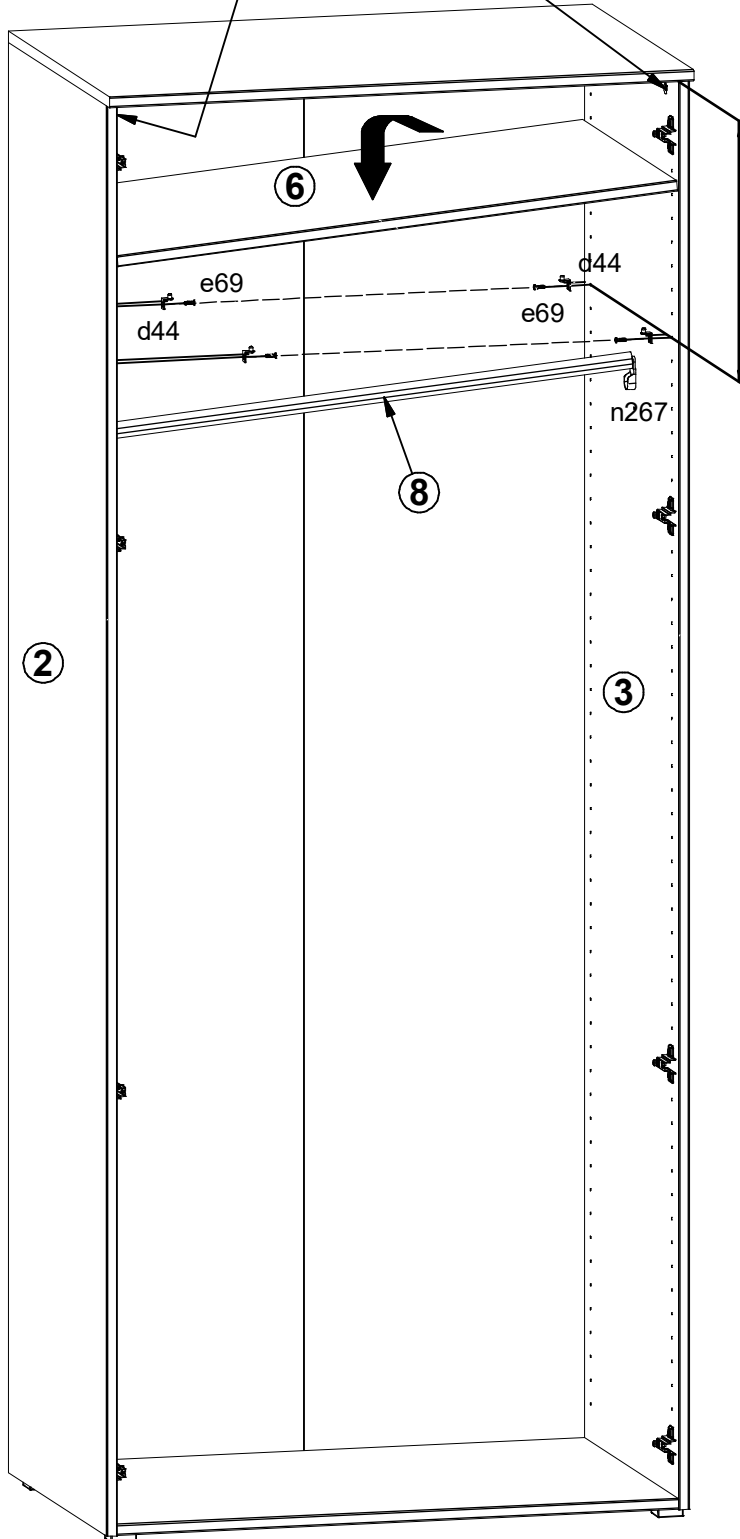
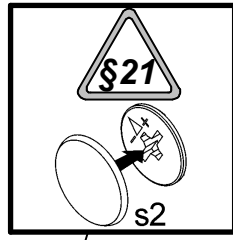

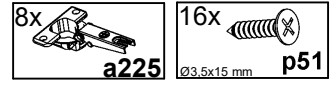
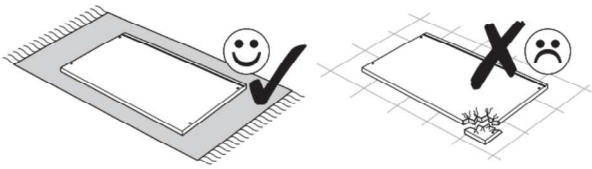

12  
2x

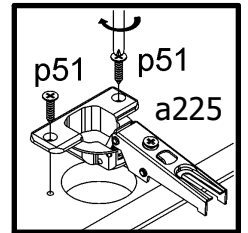
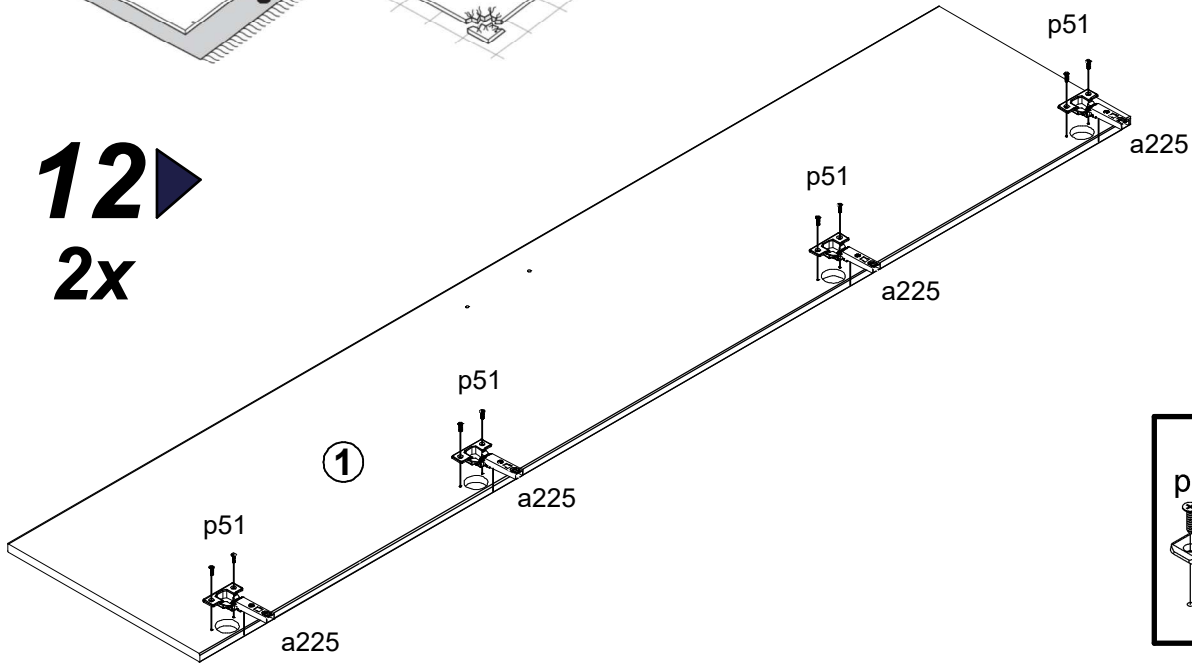

13

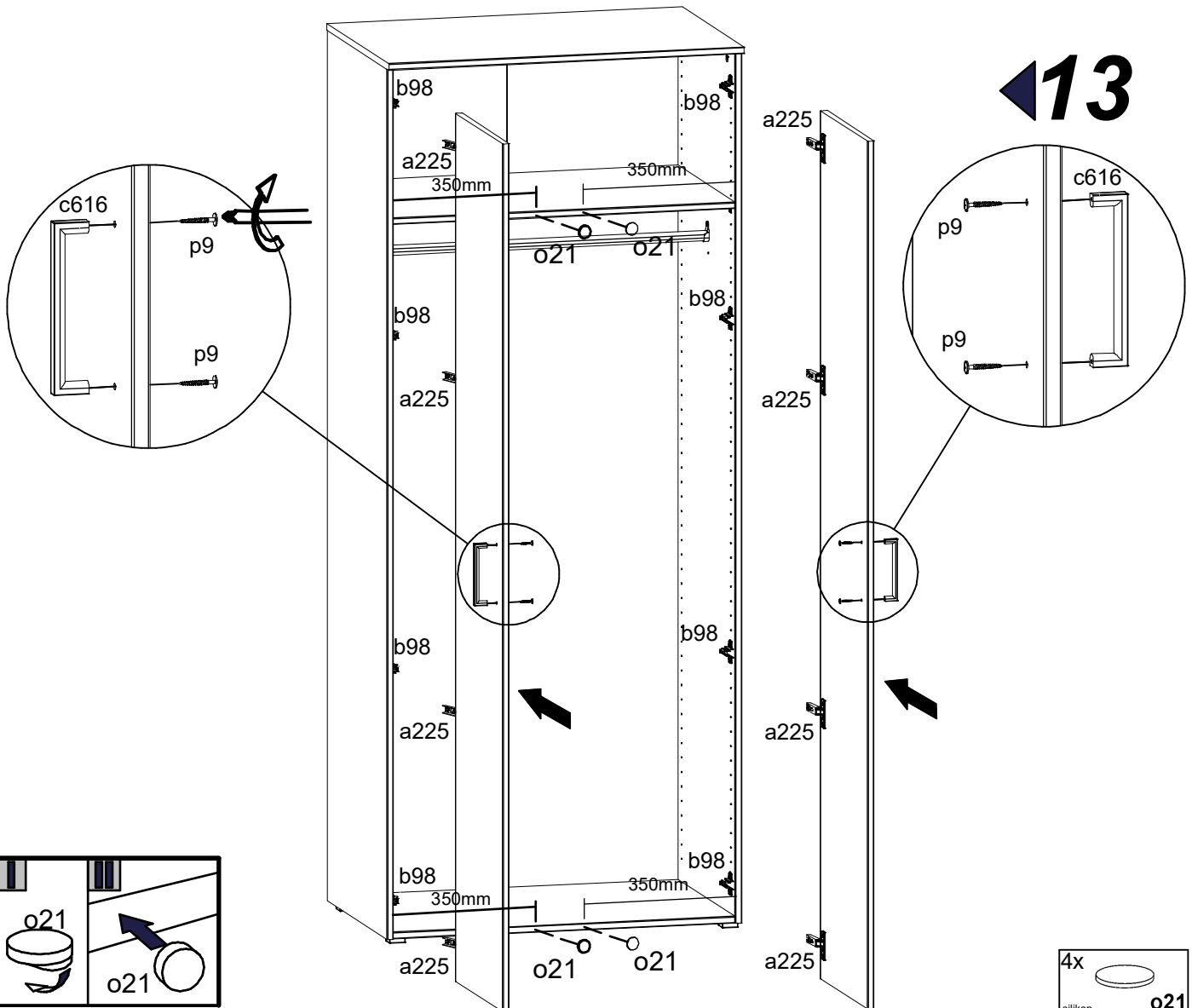

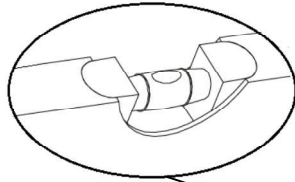
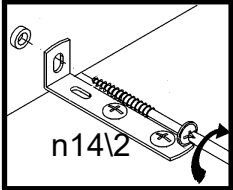
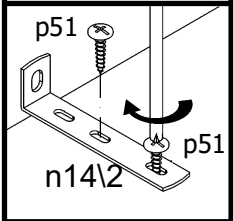
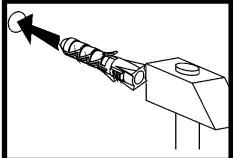
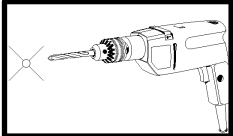

p51  
n142

4

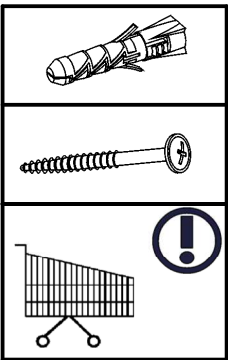
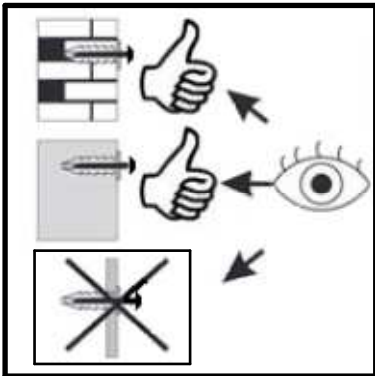
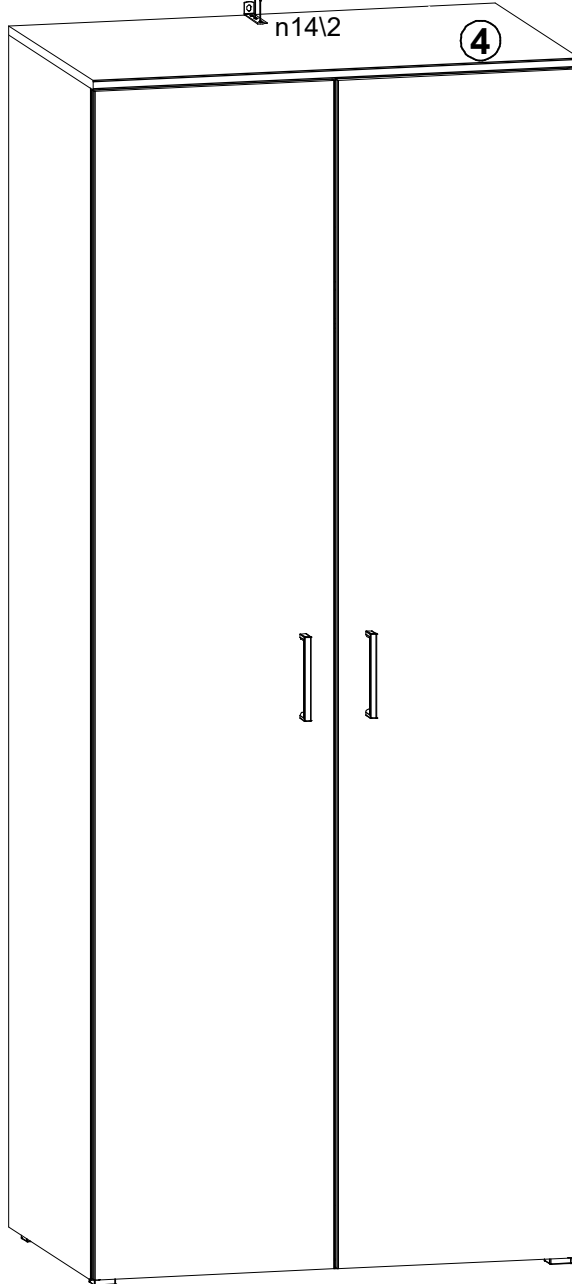

2x p51  
Ø3,5x15 mm

1x n142  
86x21x19,5

