

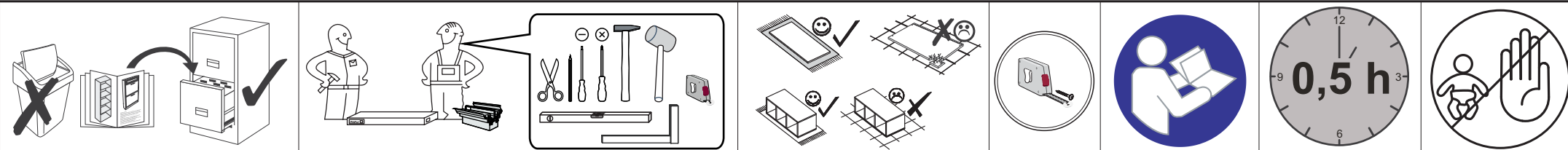

- (GB) Assembly instructions
- (DE) Montageanleitung
- (FR) Notice de montage
- (NL) Handleiding voor de montage
- (IT) Istruzioni di montaggio
- (HU) Szerelési útmutató
- (ES) Instrucciones de montaje
- (PL) Instrukcja montażu
- (CZ) Montát'ní návod
- (SK) Návod na montát'
- (HR) Montat'e
- (TR) Montaj talimat
- (RO) Instrucțiuni de montaj
- (RU) Инструкции по монтажу

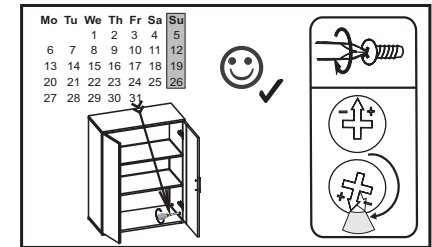
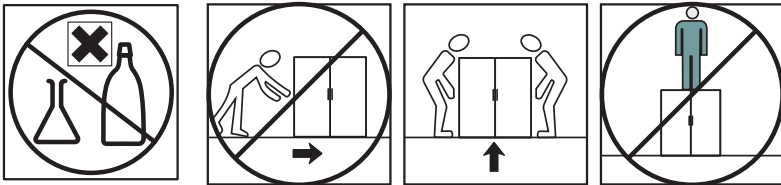
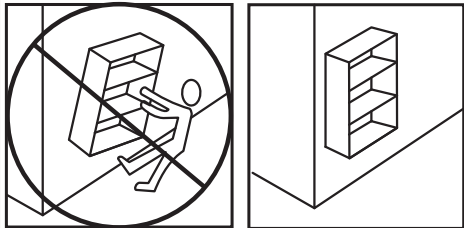
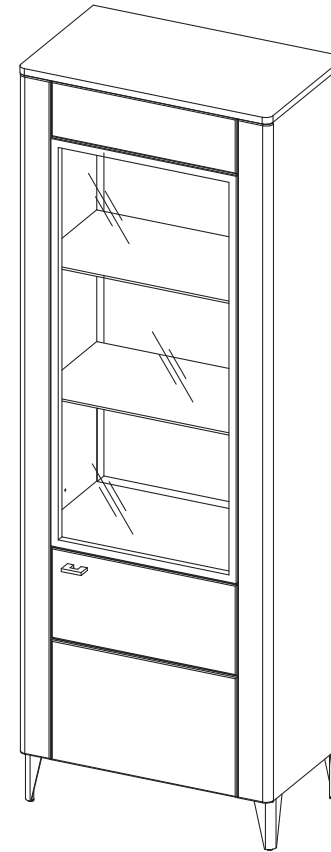

## Service • Assistenza • Dienstverlening • Serwis Servis • Szerviz • Servizio • Usluga •

Name • Nom • Nome • Naam • Nazwa Jméno • Názov • Név • Denumire Nombre • Ime • Isim	<b>Latina</b>
Nr. • No. • N° • Íriéid • Ć • Sz • Ne	
Typ • Type • Tip • Típus • Tipo	<b>11</b>

shop • geschäft • boutique • sklep • winkel •  
negozio • bolt • tienda • obchod • dučan • mađaza • magazin

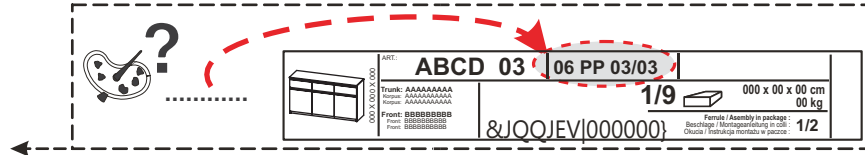
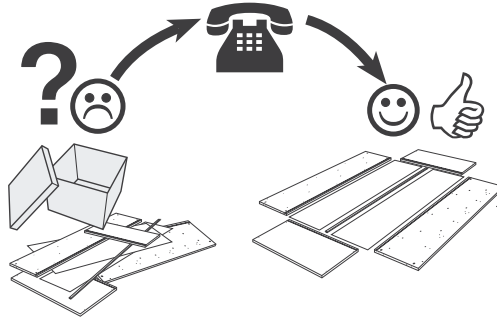

<b>M1</b> X...	<b>D10</b> X...	<b>S2</b> 3x13 X...
<b>T1</b> X...	<b>P6</b> 4x35 X...	<b>S12</b> 4x30 X...
<b>B1</b> fi 8x28 X...	<b>S10</b> 3,5x25 X...	<b>F70</b> X...
<b>M4</b> X...	<b>W10</b> X...	<b>E1</b> 6,3x13 X...
<b>Z17</b> fi 35 KR90 X...	<b>T16</b> M6 X...	<b>L10</b> X...
<b>Z17s</b> fi 35 KR90 X...	<b>G1</b> X...	
<b>S9</b> 4x16 X...		

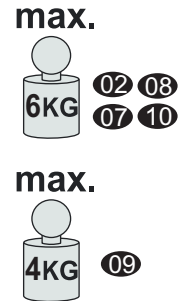
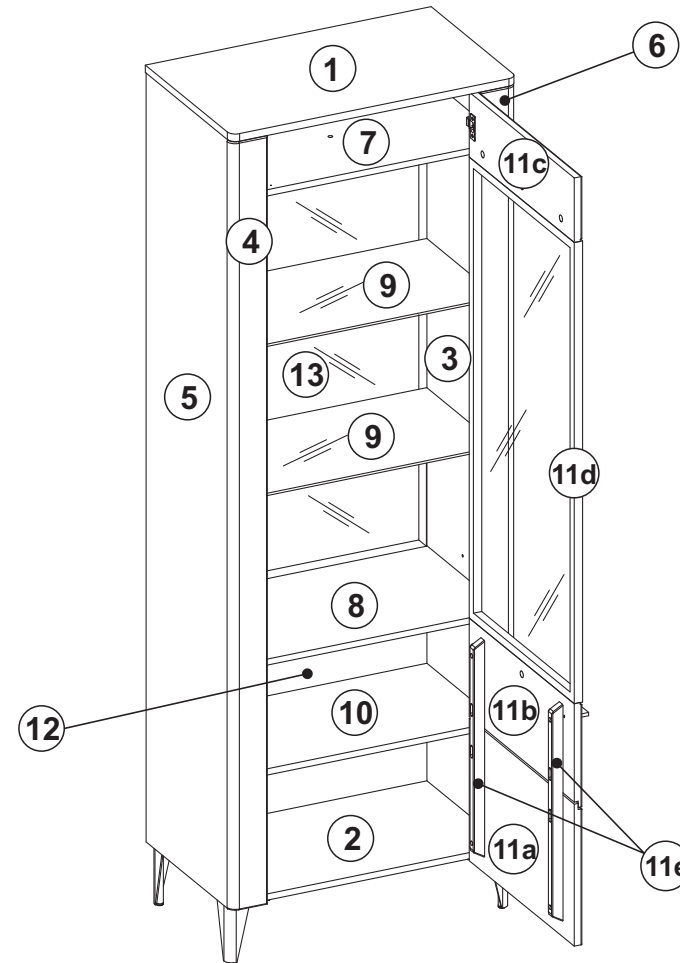

1

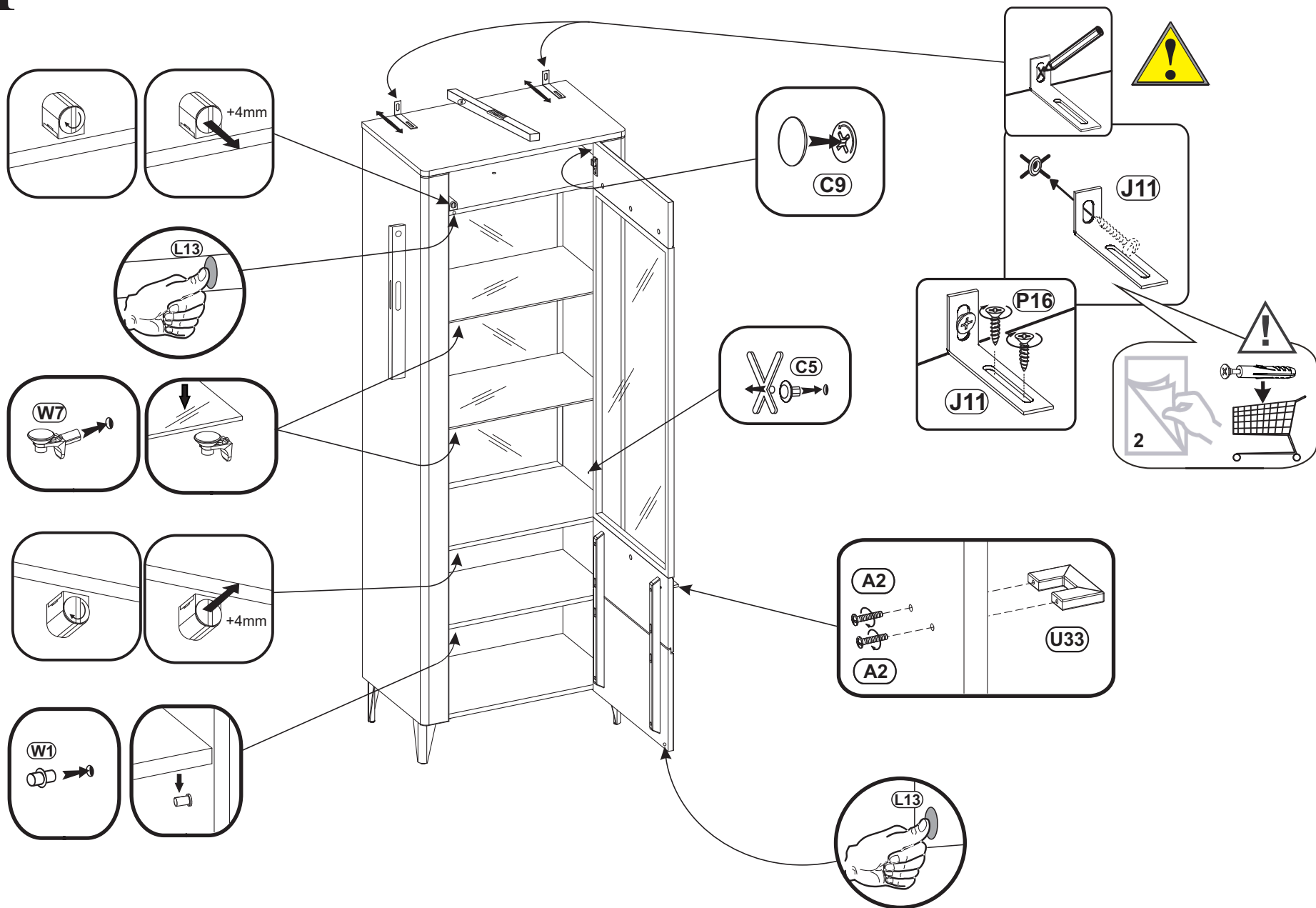

- W7** x8
- W1** x4
- C5** fi 5 x2
- C9** fi 20 x14
- L13** SJ x2
- J11** x2
- P16** 4x16 x4
- A2** M4x25 x2
- U33** C-2951 x1



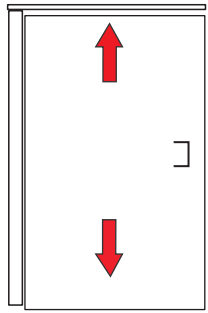

1

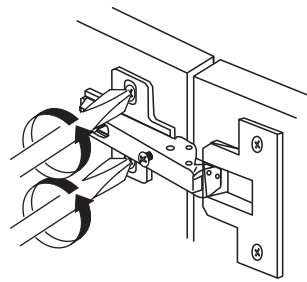

2

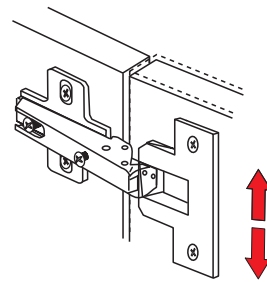

3

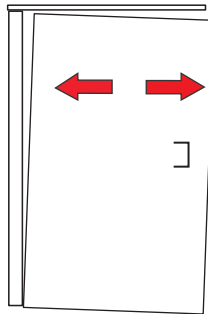
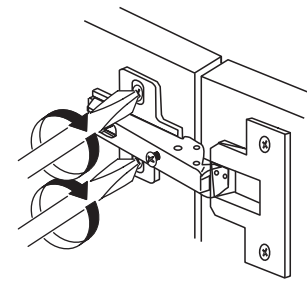

1

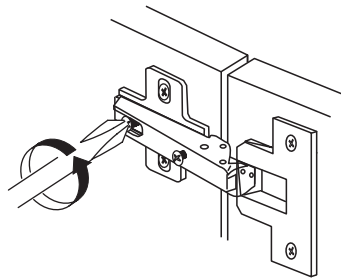

2

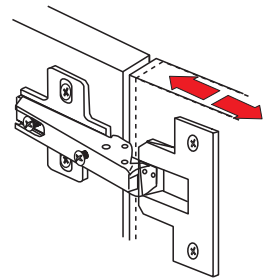

3

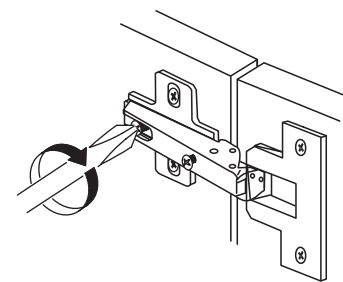

1

